



### 11 Adler Court Keilor Downs VIC

4 2 4

An exceptional opportunity awaits you to own a home of unparalleled construction quality. Nestled within one of suburb's most desirable neighbourhoods.

This locale boasts a rare collection of double-built and tightly held generational homes, exemplifying a commitment to lasting excellence. Don't let this limited opportunity slip through your fingers to acquire a residence in arguably Melbourne's finest family-oriented suburb, offering outstanding value.

Nestled in a serene and secure court, this brick residence makes a grand first impression with its unique architectural style. As you step inside this impeccably maintained update home, you'll be greeted by soaring cathedral ceilings and an abundance of strategically placed windows, welcoming copious amounts of natural light into the living spaces.

**Price** : \$ 938,000  
**Land Size** : 761 sqm  
**View** : <https://www.douglaskay.com.au/sale/vic/north-west/keilor-downs/residential/house/7800128>



**Adrian Kay**  
03 9313 7888



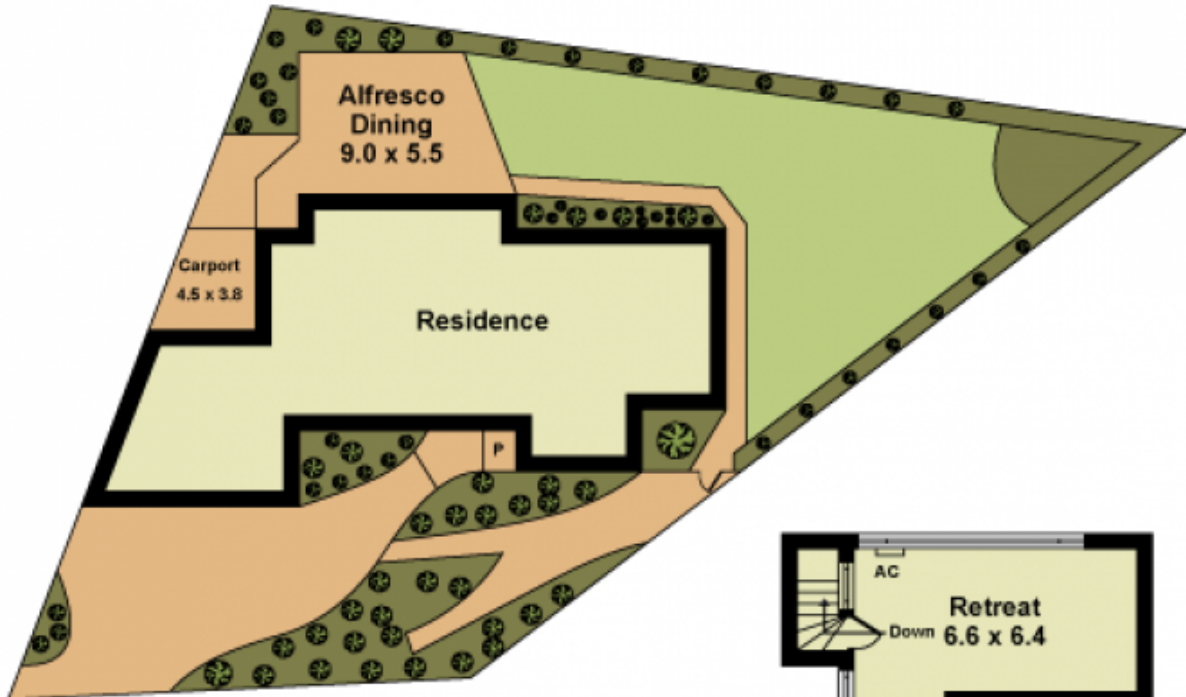

SITE PLAN



FIRST FLOOR



GROUND FLOOR

Whilst every attempt has been made to ensure the accuracy of this floorplan, measurements of doors, windows, rooms and any other items are approximates only. The producer or agent cannot be held responsible for any errors, omissions or misstatements. This plan is for illustrative purposes only and should be used as such.