



**22 Imperial Avenue Sunshine North VIC**

4 🚗

Total building Area 305m2  
Container height roller door  
Gated and fenced with onsite parking  
Reception area and 1st floor offices  
Kitchenette and Bathroom  
3-phase power  
Quick access to McIntyre Rd and Western Ring Rd

**Building Size** : 305 sqm  
**View** : <https://www.douglaskay.com.au/lease/vic/west/sunshine-north/commercial/industrial/7795021>



**Nick Christopoulos**  
03 9313 7888



**Chinh Pham**  
03 9313 7888

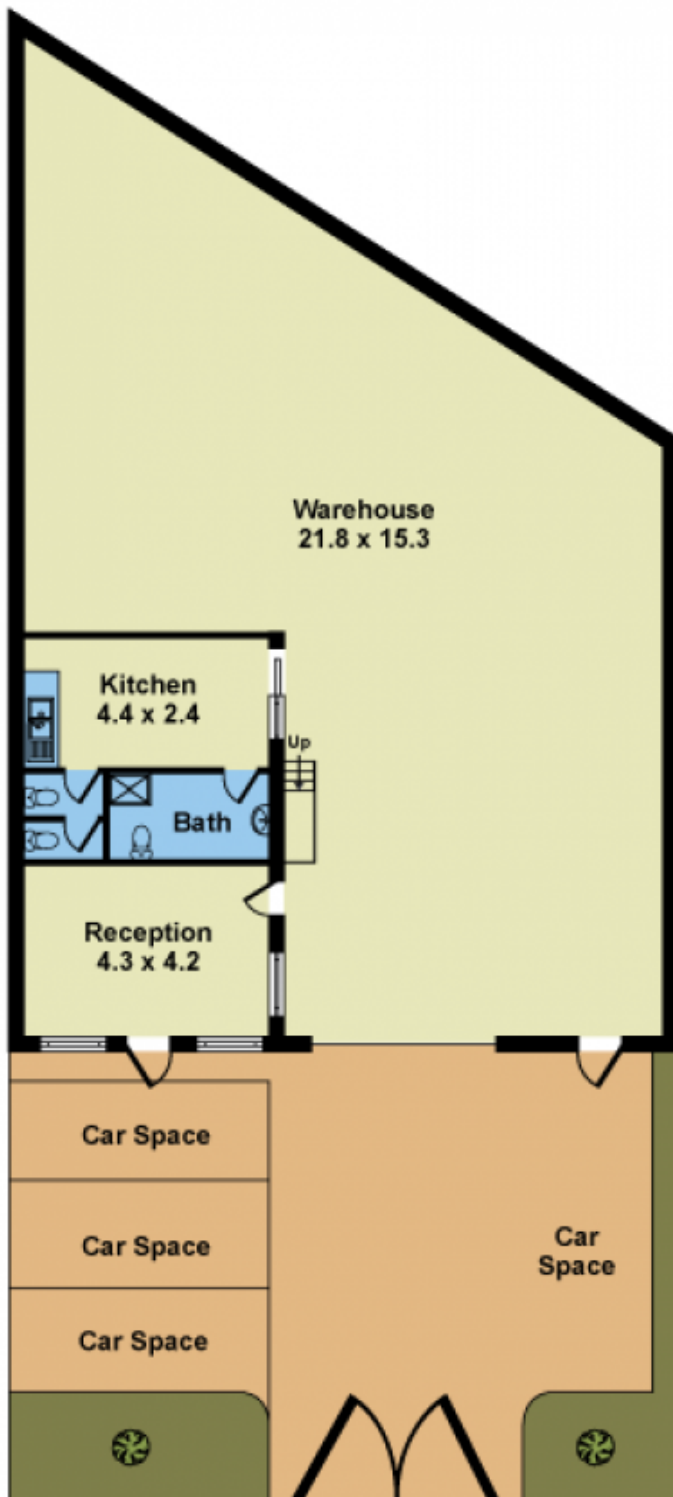

**GROUND FLOOR**

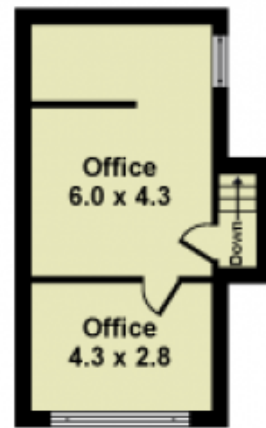

**FIRST FLOOR**

Whilst every attempt has been made to ensure the accuracy of this floorplan, measurements of doors, windows, rooms and any other items are approximates only. The producer or agent cannot be held responsible for any errors, omissions or misstatements. This plan is for illustrative purposes only and should be used as such.