



36B Lynch Street Sunshine VIC

2 1 2

Featuring an abundance of space and in Sunshine's most desirable location.

This very big double-story home comprises of two bedrooms one with walk in robe and the 2nd with built in robe, study room, new carpet, new floor board and new painting. a large open plan living room, adjoining kitchen and dining room. Extra features include a spacious modernised kitchenette with stainless steel appliances.

Central heating, split system, security lock up garage, 2.55 height ceiling and many more features.

Centrally located in the heart of Sunshine CBD just off Hertford Road and Ballarat Road, close to all

Type : Townhouse

View : <https://www.douglaskay.com.au/lease/vic/west/sunshine/residential/townhouse/7300515>

[For full version visit the website](https://www.douglaskay.com.au)



SITE PLAN

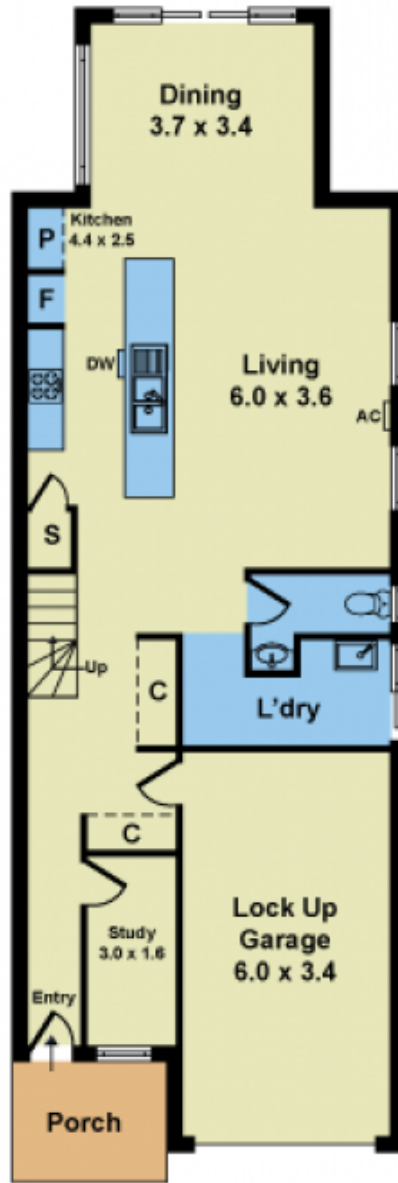

GROUND FLOOR

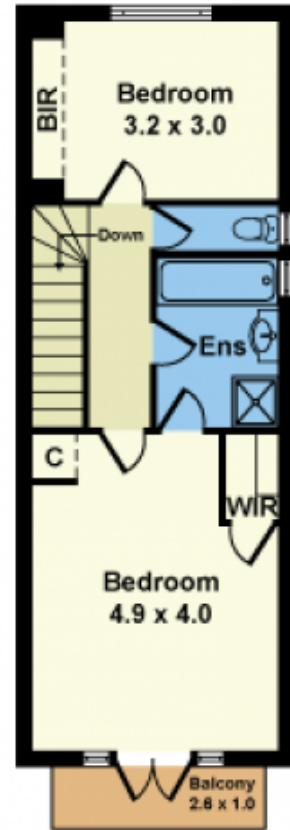

FIRST FLOOR

Whilst every attempt has been made to ensure the accuracy of this floorplan, measurements of doors, windows, rooms and any other items are approximates only. The producer or agent cannot be held responsible for any errors, omissions or misstatements. This plan is for illustrative purposes only and should be used as such.