

2/2 McLaughlin Street Ardeer VIC

5  4  2 

You've never seen anything like this. A one of a kind street facing, premium brand new development. In a sought after locale which will intrigue and dazzle.

View : <https://www.douglaskay.com.au/lease/vic/west/ardeer/residential/townhouse/7128665>

A superb minimal design is contemporary and edgy while understated. Sharp lines, glass balustrade mixed with steel and timber exteriors are bold and effortless with a sense of cool.

An expansive floorplan opens with a formal entrance, ground bedroom and bathroom, study nook, open plan living, kitchen with island bench and full laundry. Upstairs you will find the master with ensuite, central tiled bathroom, bedrooms 3 & 4 all with built in robes. The flow continues through black aluminium sliding doors to a low maintenance landscaped yard and true double car sized garage.



GROUND FLOOR

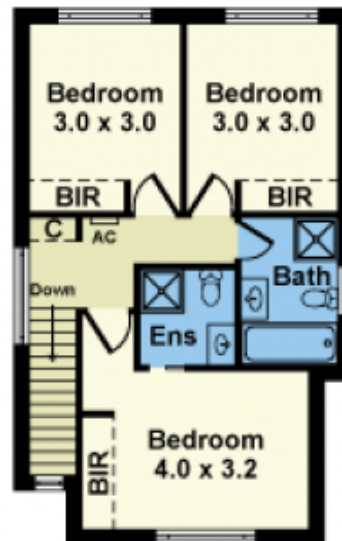

FIRST FLOOR

Whilst every attempt has been made to ensure the accuracy of this floorplan, measurements of doors, windows, rooms and any other items are approximates only. The producer or agent cannot be held responsible for any errors, omissions or misstatements. This plan is for illustrative purposes only and should be used as such.